

Devon Community Resilience Forum

Helping You To Help Yourself

DEVON COMMUNITY RESILIENCE FORUM

December 2017

Another great day for community resilience

Community representatives from Parish and District Councils across Devon congregated on the 22nd November at The Kenn Centre, Kennford, for the fifth Devon Community Resilience Forum. The event was very well attended with over 80 delegates and specialist suppliers.

Elaine Cook, CEO, Devon Communities Together, chaired the day and introduced a number of speakers and emergency response experts, including:

- Cllr Barry Parsons, who gave an update on the Devon County Council future strategy.



- Debbie Carrig from the British Red Cross, who explained how the BRC responds in times of emergency and also about Community Reserve Volunteers (www.bit.ly/BRC-Volunteers).

- Geoff Jung (Wodbury) and Lynne Easton (Chew Magna) provided excellent case studies of how their communities

developed community emergency plans and how this has helped them deal with emergencies.

Following a sociable lunch, where delegates had plenty of opportunity to share their experiences and visit stall holders in the Marketplace, all delegates took part in workshops, designed to inform and offer advice on emergency planning from the beginner to the experienced. These included:

- Risk assessments and insurance.
- Recruiting volunteers.
- Using walkie talkie two-way radios.

Facilitators reported a big turnout for the afternoon workshops, facilitated by Came & Co, Lynne Easton and Kate Pearson (Environment Agency) and WO2 Elliot Drake (6 RIFLES) who generously took time off from their daily responsibilities to share their knowledge and experience.

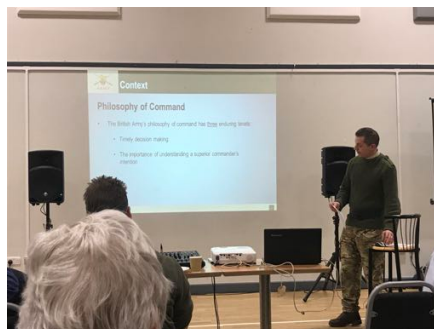

Summing up, Elaine encouraged delegates to pass the word and the opportunity to join the forum to their neighbouring communities.

There was a community atmosphere throughout the day and we look forward to the next forum event planned for May 2018.

Delegates and exhibitors wishing to attend the next event can register their interest by emailing info@devoncommunities.org.uk quote ref: DCRF18

Meanwhile, please join the conversation:

Facebook: <http://on.fb.me/1jYctSK>

Twitter: @DevComsTogether
#devonresilience

Visit our forum website, brimming with templates, advice and case studies.
www.bit.ly/Devon-Forum

Winter service is an important part of Devon County Council's maintenance work and almost £5 million is spent each year on roads affected by winter weather. This involves salting major roads when there is a risk of ice, clearing snow and reacting to floods and fallen trees.

The Council's contractor, Skanska has a workforce based at strategic locations to provide an effective response to any problems that may occur.



Despite Devon County Council's efforts, winter weather can still make roads treacherous. With over 90% of all crashes attributed to human error the real key to

driving in winter is to drive with due care for the conditions. Never assume a road has been salted.



More information can be found in the DCC leaflet here www.bit.ly/travelling-in-winter

More information on roads and transport can be found at www.bit.ly/roads-and-transport



Community Landing Sites

Devon Air Ambulance Trust *real people saving real lives*

Devon Air Ambulance Trust (DAAT) works with communities throughout Devon to establish a network of landing sites to support their night flying operations.

As the network of landing sites is steadily growing they are able to offer communities an extended service until midnight.

Devon Air Ambulance works with communities to develop a network of pre-surveyed floodlit 'community landing sites' which enables them to bring a life-saving service into the heart of those communities when it is dark.

A community landing site, which is developed and part-funded by the local community, could be located on a green field or sports pitch. Key features of a night landing site include:

- it needs to be a flat open area of at least 50m x 50m
- it could be on grass, tarmac or concrete
- it needs pedestrian access onto the site and vehicle access close by
- a nearby power source for lighting is useful although not essential
- tall trees or power lines within the site might be a hazard, however if they are on the periphery they may not cause a problem

To find out more about community landing sites please visit www.bit.ly/DAAT-nightflight

If you would like to find out if there is a night landing site being developed in your area please look at the landing sites in your area by following this link

www.bit.ly/DAAT-landing-sites

For further information on the network please contact Toby Russell, DAA's



Community Landing Site Development Officer on 01392 466666/07943 207673 or you can email him t.russell@daat.org

Devon Air Ambulance Trust
Registered Charity No: 207998



Red Cross first aid app



If a friend or family member was having a heart attack or was choking, would you know how to help them?

The British Red Cross free app features simple, easy advice on 18 everyday first aid scenarios, as well as tips on how to prepare for emergencies, from severe winter weather to road traffic accidents.



With videos, interactive quizzes and simple step-by-step advice, it's never been easier to learn first aid.

The information you need is all hosted

on the app itself, meaning no internet connection is needed, making it fast and easy to access.

Download the app

Visit the Apple App Store www.bit.ly/apple-red-cross or the Google Play Store www.bit.ly/google-red-cross.

Share the app

By sharing this app, you can help save lives. Show it off to all your friends and family and get them to download it too.

For more information on this and the Baby and Child First Aid app visit British Red Cross www.bit.ly/british-red-cross

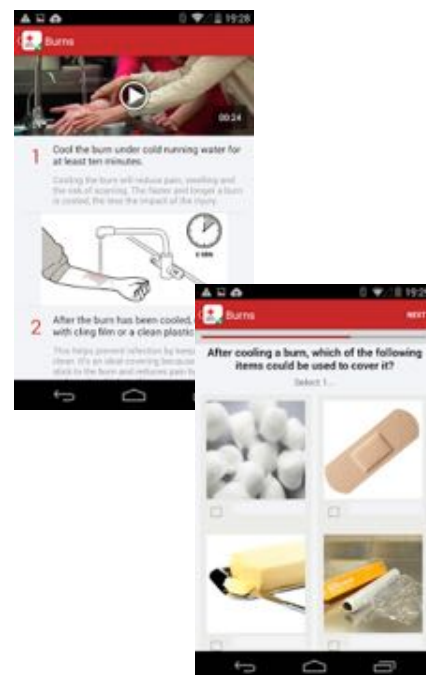

'Storm selfies' are risking lives



Get ready  for winter

As winter storms make their presence felt, we are reminded that incidents of selfie related injuries continue to rise at an alarming rate. Therefore the Environment Agency and the Royal Society for the Prevention of Accidents (RoSPA) are warning that people posing for 'storm selfies' are putting their lives in danger.

Recently, coastal flooding led to people taking unnecessary risks to capture dramatic moments along the country's coastline. Videos of people getting swept along roads by waves even became internet hits.

David Walker, leisure safety manager at RoSPA, said:

"We understand the temptation to view powerful tides and weather conditions, however, if you get caught up or swept out to sea in these events your life will be at risk very quickly and our rescue services will also be at great risk. Listen to the advice of the coastguard and the

police about safe places to be. Floods are devastating so do not be afraid to seek medical help or support."

Top tips to stay safe

- Try to avoid walking through flood water because there may be hidden hazards such as potholes and missing manhole covers.
- If you have to walk in a flooded area, be aware of the power of moving water, try to wear waders and take a stick to check the ground in front of you as this may save your life.
- Sign-up for the Environment Agency's free flood warnings, listen out for National Severe Weather Warnings from Met Office www.bit.ly/Weather-Warnings and following advice from coastguards.
- Do not try to capture scenes of severe weather by taking 'selfies', getting too close to rough seas or walking in

exposed areas. Stay safe and consider whether it's necessary to venture out.

For more information visit the Met Office website at www.bit.ly/storm-selfies



There are practical steps you can take to support your community in preparing for winter weather.

Winter weather can be beautiful, with clear blue skies and crisp snow. But in reality, we experience a whole range of severe weather that can have a major impact on communities. There are practical ways in which you can support your community in preparing for this.

It may be that your community is in an area susceptible to flooding, so you might want to get involved in helping to prepare for, and respond to flooding. It's not just your home that may be impacted by flooding, it's also businesses, schools and community venues.

Snow and ice is likely to affect us all at some point over the winter. Not only can it severely impact travel plans, but it can also really affect access to your home and to community buildings. Members of your community who are elderly and less mobile can be particularly affected by snow and ice, so there are ways in which you can ensure they don't get isolated.

It's not just individuals that can be affected in severe weather, it's also businesses and people's livelihoods. It may be a local farmer affected, or a small local business. Whether it's access to a building or site, or damage caused by weather, it still has an impact.

There is lots of information and guidance to download at www.bit.ly/winter-communities including:

- What to do in heavy rain
- What to do in widespread ice
- What to do in dense fog



- What to do in heavy snow
- What to do in strong winds

Further information and support

For assistance with community Emergency Planning your first point of contact is your City, District or Borough Emergency Planning Officer.

You will find them listed below for reference and remember they are all there to help you!

Don't forget, the Devon Communities Together website has lots of useful information for both individuals and communities:

- www.devoncommunities.org.uk
- [What we do](#)
- [Devon Community Resilience Forum](#)

Useful information:

CLEAR Plan	www.dcisprepared.org.uk/a-clear-plan
Floodline	0345 988 1188
Environment Agency	www.gov.uk/flood
Consumer Council for Water	www.ccwater.org.uk
National Flood Forum	www.floodforum.org.uk
Blue Pages Directory	www.bluepages.org.uk
Association of British Insurers	www.abi.org.uk or 020 7600 3333
British Insurance Brokers Association	www.biba.org.uk or 0870 950 1790
Royal Institute of Chartered Surveyors	www.rics.org/flooding
Know Your Flood Risk campaign	www.knowyourfloodrisk.co.uk

Mid Devon	East Devon	North Devon	Teignbridge	South Hams/ West Devon	Torrige	Exeter
Julia Ryder 01884 234997 jryder@middevon.gov.uk	Pam Harvey 01395 516551 pharvey@eastdevon.gov.uk	Amanda Palmer 01271 388760 amanda.palmer@devon.gov.uk	epu@teignbridge.gov.uk	James Kershaw 01803 861287 james.kershaw@swdevon.gov.uk	Richard Haste 01237 428963 richard.haste@torridge.gov.uk	Gill Wheelright 01392 277888 gill.wheelright@exeter.gov.uk