



Devon Community Resilience Forum

Helping You To Help Yourself



December 2015

A great day for resilience



Community representatives from local, Parish and District Councils across Devon congregated on the 10th November at Fingle Glen golf resort, Tedburn St. Mary for the first Devon Community Resilience Forum. This inaugural event was very well attended with over 100 delegates and specialist suppliers.

Elaine Cook, CEO, Devon Communities Together, chaired the day and introduced a number of professional speakers and emergency response experts, including:

- Assistant Chief Constable, Paul Netherton, Devon and Cornwall Police Context and the importance of resilience



- Dom Maxwell-Batten, Chair of Devon Community Resilience Forum Background, structure and overview of the forum

- Mary Dhonau, MDA Consultants – Queen of Floods Community experiences and impact of resilience work

- Matt Herdman, Operations Watch

Manager, Devon & Somerset Fire & Rescue Service, Dramatic community examples and impact of resilience

Following a sociable lunch, where delegates had plenty of opportunity to share their experiences and visit stall holders in the Marketplace, all delegates took part in workshops, designed to inform and offer advice on emergency planning from the beginner to the experienced.

Facilitators reported a big turnout for the afternoon workshops, facilitated by Devon Communities Together, the Environment Agency, Teignbridge District Council, Plymouth City Council and Devon County Council and represented by the communities of Branton, Tiverton, Feniton and Brixham, who generously took time off from their daily responsibilities to share their knowledge and experience of Emergency Planning with less experienced communities.

Summing up, Elaine encouraged delegates to pass the word and the

BE RESILIENT



BE PREPARED

opportunity to join the Forum to their neighbouring communities and announced to the Forum details of a new Resilience Grant being delivered together with Devon Community Foundation (watch this space for announcements), plus details on the future training activities being developed.

There was a community atmosphere throughout the day and we look forward to the next forum event planned for May 2016.

Delegates and exhibitors wishing to attend the next event can register their interest by emailing info@devoncommunities.org.uk quote ref: DCRF16

Meanwhile, please join the conversation:
Facebook: <http://on.fb.me/1jYctSK>
Twitter: @DevComsTogether
#devonresilience

Visit our forum website, brimming with templates, advice and case studies. <http://bit.ly/Devon-Forum>





Don't let your business count the cost of a flood

In 2013-14, the wettest winter on record saw 3,200 commercial properties flooded and 7,700 homes flooded. While the costs to businesses are still being counted from these floods, we know they can be high; the economic cost of the 2012 floods is estimated to be £70,222 for each business flooded.

There are around 260,000 business units employing 3.2 million people located in areas at risk of flooding and flooding is set to become more common as the climate changes.

The Environment Agency encourages people to think about what a flood could mean to their home and business and take action.

Have you ever considered the impact

flooding could have on your business? Are your employees, business operations, supply chain or customer base at risk?

There are simple steps you can take to help protect your business from flooding and to get ready for a changing climate.

- Sign-up for free flood warnings for your area at www.bit.ly/warnings-sign-up
- Develop a business flood plan at www.bit.ly/business-flood-plan
- Complete a free business resilience healthcheck and get a personalised report about how your business can prepare for flooding and severe weather at www.bit.ly/business-healthcheck

Take these small steps now for free and help protect your business and your bottom line.

OPEN FOR BUSINESS?



Severe Weather

A more resilient small business community



Federation of Small Businesses
The UK's Leading Business Organisation

The Federation of Small Businesses (FSB) is the UK's leading business organisation. They exist to protect and promote the interests of the self-employed and those who run their own business.

Small firms make up over 99 per cent of all businesses in the UK, and make a huge contribution to our economy. They account for a third of all private sector turnover and employ almost half of the private sector workforce. A large proportion of these small firms are microbusinesses (fewer than 10 employees) and sole-traders.

was just the latest reminder about the impact that the weather can have on our communities and small businesses, as well as our wider economy.

The Federation of Small Businesses has produced a report detailing findings and recommendations and this can be downloaded at

www.bit.ly/resilient-business

"Two thirds of small businesses say they have been negatively affected by severe weather in the last three years."

"Only 25 per cent of microbusinesses (those with fewer than 10 employees) have a resilience plan in place that specifically includes severe weather."

The flooding and storm damage that badly affected parts of the UK in 2013-14



Red Cross first aid app



If a friend or family member was having a heart attack or was choking, would you know how to help them?

The British Red Cross free app features simple, easy advice on 18 everyday first aid scenarios, as well as tips on how to prepare for emergencies, from severe winter weather to road traffic accidents.



With videos, interactive quizzes and simple step-by-step advice, it's never been easier to learn first aid.

The information you need is all hosted

on the app itself, meaning no internet connection is needed, making it fast and easy to access.

Download the app

Visit the Apple App Store www.bit.ly/apple-red-cross or the Google Play Store www.bit.ly/google-red-cross.

Share the app

By sharing this app, you can help save lives. Show it off to all your friends and family and get them to download it too.

For more information on this and the Baby and Child First Aid app visit British Red Cross www.bit.ly/british-red-cross

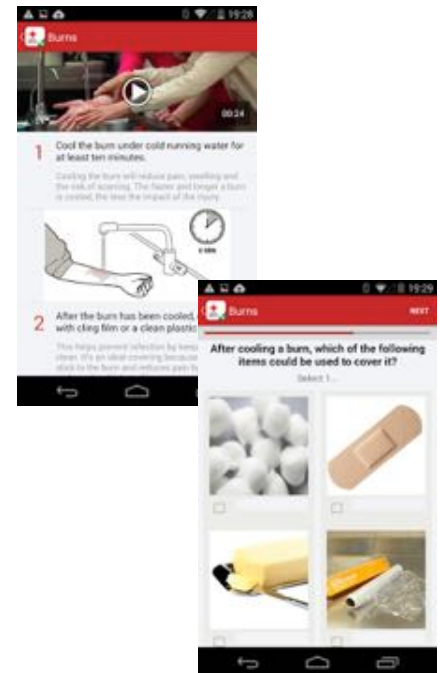

'Storm selfies' are risking lives



Get ready  for winter

As Storm Barney makes his presence felt, we are reminded that incidents of selfie related injuries continue to rise at an alarming rate. Therefore the Environment Agency and the Royal Society for the Prevention of Accidents (RoSPA) are warning that people posing for 'storm selfies' are putting their lives in danger.

Last year, coastal flooding led to people taking unnecessary risks to capture dramatic moments along the country's coastline. Videos of people getting swept along roads by waves even became internet hits.

David Walker, leisure safety manager at RoSPA, said:

"We understand the temptation to view powerful tides and weather conditions, however, if you get caught up or swept out to sea in these events your life will be at risk very quickly and our rescue services will also be at great risk. Listen to the advice of the coastguard and the

police about safe places to be. Floods are devastating so do not be afraid to seek medical help or support."

Top tips to stay safe

- Try to avoid walking through flood water because there may be hidden hazards such as potholes and missing manhole covers.
- If you have to walk in a flooded area, be aware of the power of moving water, try to wear waders and take a stick to check the ground in front of you as this may save your life.
- Sign-up for the Environment Agency's free flood warnings, listen out for National Severe Weather Warnings from Met Office www.bit.ly/Weather-Warnings and following advice from coastguards.
- Do not try to capture scenes of severe weather by taking 'selfies', getting too close to rough seas or walking in

exposed areas. Stay safe and consider whether it's necessary to venture out.

For more information visit the Met Office website at www.bit.ly/storm-selfies



There are practical steps you can take to support your community in preparing for winter weather.

Winter weather can be beautiful, with clear blue skies and crisp snow. But in reality, we experience a whole range of severe weather that can have a major impact on communities. There are practical ways in which you can support your community in preparing for this.

It may be that your community is in an area susceptible to flooding, so you might want to get involved in helping to prepare for, and respond to flooding. It's not just your home that may be impacted by flooding, it's also businesses, schools and community venues.

Snow and ice is likely to affect us all at some point over the winter. Not only can it severely impact travel plans, but it can also really affect access to your home and to community buildings. Members of your community who are elderly and less mobile can be particularly affected by snow and ice, so there are ways in which you can ensure they don't get isolated.

It's not just individuals that can be affected in severe weather, it's also businesses and people's livelihoods. It may be a local farmer affected, or a small local business. Whether it's access to a building or site, or damage caused by

weather, it still has an impact.

There is lots of information and guidance to download including:

- What to do in heavy snow
- What to do in strong winds
- What to do in heavy rain
- What to do in widespread ice
- What to do in dense fog

at www.bit.ly/winter-communities

Useful information:



CLEAR Plan	www.dcisprepared.org.uk/a-clear-plan
Floodline	0345 988 1188
Environment Agency	www.gov.uk/flood
Consumer Council for Water	www.ccwater.org.uk
National Flood Forum	www.floodforum.org.uk
Blue Pages Directory	www.bluepages.org.uk
Association of British Insurers	www.abi.org.uk or 020 7600 3333
British Insurance Brokers Association	www.biba.org.uk or 0870 950 1790
Royal Institute of Chartered Surveyors	www.rics.org/flooding
Know Your Flood Risk campaign	www.knowyourfloodrisk.co.uk

Further information and support

For assistance with community Emergency Planning your first point of contact is your City, District or Borough Emergency Planning Officer.

You will find them listed below for reference and remember they are all there to help you!

Don't forget, the Devon Communities Together website has lots of useful information for both individuals and communities:

-  www.devoncommunities.org.uk
-  [How can we help you](#)
-  [Devon Community Resilience Forum](#)

Mid Devon	East Devon	North Devon	Teignbridge	South Hams/ West Devon	Torridge	Exeter
						
Julia Ryder 01884 234997 jryder@ middevon.gov.uk	Pam Harvey 01395 516551 pharvey@ eastdevon.gov.uk	Amanda Palmer 01271 388760 amanda.palmer@ northdevon.gov.uk	Ian Flood-Page 01626 215835 iflood@ teignbridge.gov.uk	James Kershaw 01803 861287 james.kershaw@ southhams.gov.uk	Richard Haste 01237 428963 richard.haste@ torridge.gov.uk	Jude Hardiman 01392 382634 judith.hardiman@ devon.gov.uk